

Polyurethane Joint Sealant
 1 3/4" Concrete Face Shell
 2 1/2" XPS Insulation
 EPS Chase For Wiring
 And Plumbing

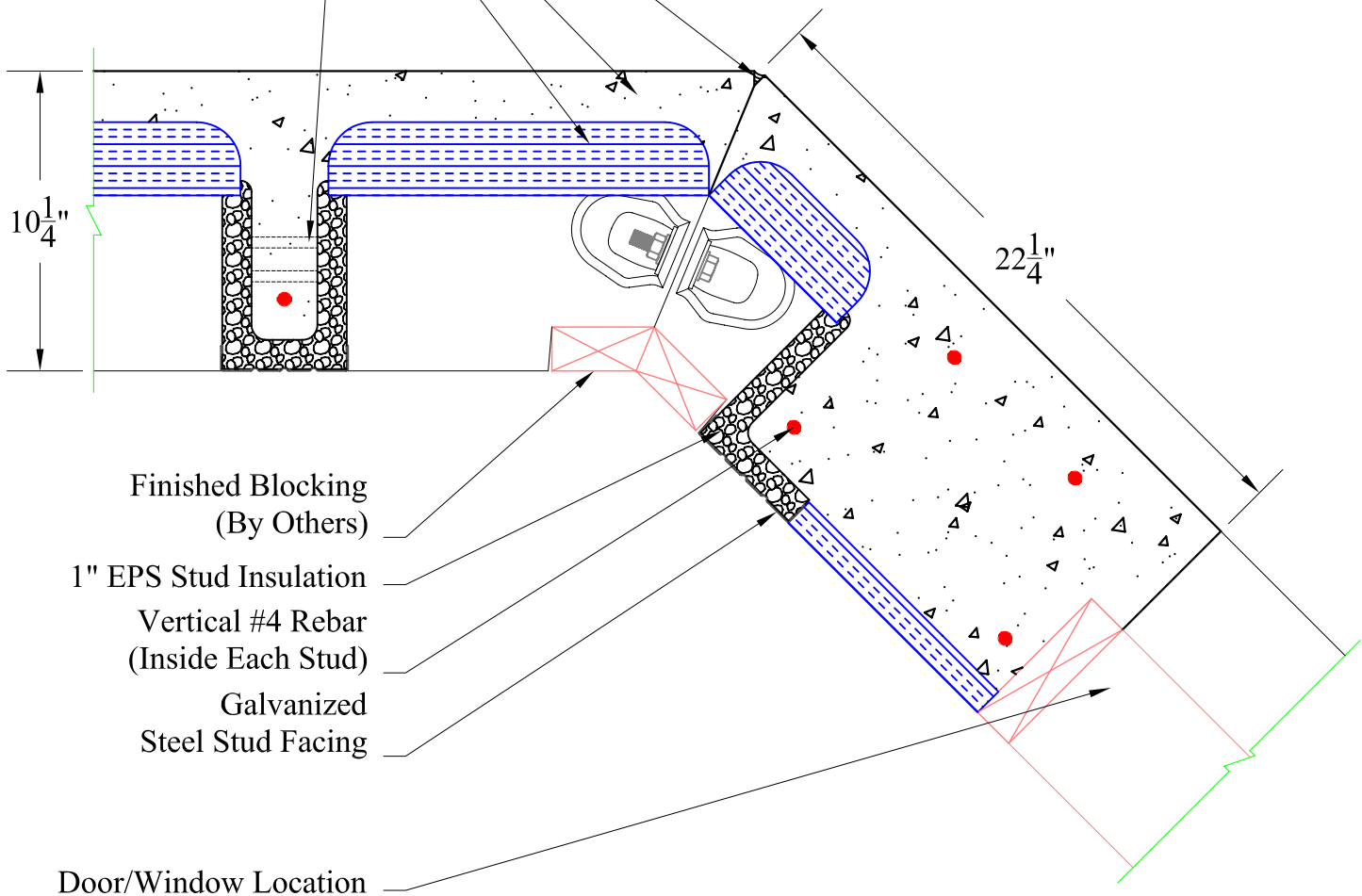

Finished Blocking
 (By Others)
 1" EPS Stud Insulation
 Vertical #4 Rebar
 (Inside Each Stud)
 Galvanized
 Steel Stud Facing
 Door/Window Location

Superior Walls
 www.superiorwalls.com
 937 East Earl Road, New Holland, PA 17557
 Phone: 800-452-9255 / Fax: 717-351-9263

	NAME	DATE	PRODUCT LINE: Xi	
DRAWING BY:	NJEI	08/23/06	DESCRIPTION: Perm. Entry or Bileo Door (Min. Dist. @ 45 Deg Corner)	
COMMENTS:	SIZE	DWG NO / PART NO:		REVISION
	A	DP0037		-
	DRAWING SCALE: 0'-2"=1'-0"		PLOT SCALE: 1:6	SHEET: 1 of 1